

Product Images

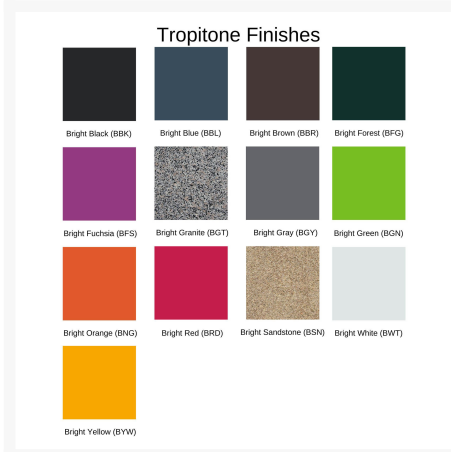

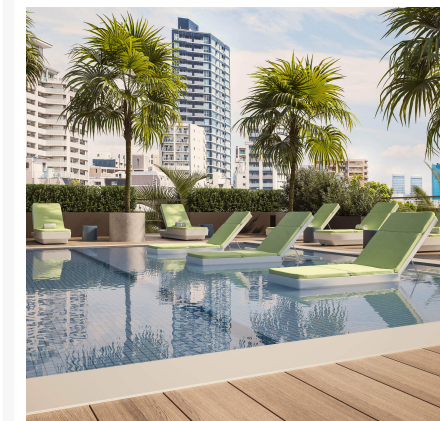

Short Description

Curve Adjustable Chaise Lounge 3A2133 by Tropitone

Description

Dive into the epitome of outdoor luxury with the Curve Adjustable Chaise Lounge (3A2133) by Tropitone, a bold fusion of style and functionality that redefines the aesthetics of outdoor spaces. The Curve Collection defies convention with its avant-garde use of Rotoform, a waterproof, marine-grade polymer product. Designed to seamlessly traverse the boundaries between land and water, this collection is the epitome of versatility, making it equally suitable for a refreshing dip or basking in the sun on a luxury hotel terrace.

Includes

- One (1) Curve Adjustable Chaise Lounge 3A2133

Dimensions

- 27" W x 82" D x 11" H (56 lbs.)
- Seat Height: 11"

Features

- Made from Rotoform, a waterproof, marine-grade polymer product, frames are durable and low-

maintenance

- Premium commercial-grade materials ensure durability and longevity for both commercial and residential spaces
- Suitable for use in or out of water, maximum water depth is 9"
- No Assembly Required

Warranty

Tropitone's warranty covers manufacturing defects; normal wear and tear is not included. With a little bit of care, your furniture will outlive the warranty for many years.

- Frame: Marine grade polymer frames are warranted for 3 years against fading and manufacturing defects

Care and Maintenance

Frame: Simply hose off or wipe down your frame to clean it! Avoid using harsh cleaners, brushes, or power washers, which could damage the finish. Take extra care when placing your furniture in humid or coastal settings; accumulation of salts and other debris can cause damage to your frame.

Covers & Storage: When not in use, we recommend using a protective cover with your furniture. During harsh weather and extreme temperatures, we recommend storing the cushions in a shed or garage and covering the frames with protective covers. If you store the frames indoors during the winter, avoid storing them upside down, which can trap moisture.

About the Manufacturer

Step into a world where travel, comfort, and style converge. Tropitone®, established in 1954 during the heyday of American road trips, began as a commercial brand that defined luxury in hotels and resorts. As travellers yearned for that same experience at home, Tropitone® answered the call, setting new standards by offering commercial-quality products for residential use. With a commitment to excellence, Tropitone® has redefined what it means to live in comfort and style. Experience a legacy that continues to shape an industry and embody the essence of adventure and luxury.

Additional Information

SKU	3A2133
Brand	Tropitone
Ships Out Estimate	4 - 5 Weeks
Residential Warranty	Frame: 3 Years

Curve Adjustable Chaise Lounge

was
\$1,934.00 Special
Price

3A2133 by Tropitone

\$1,354.00

